

# Product data sheet

## Higo - Battery - L615A

### Male front panel mount connector

L615AG C 03 DR 0300

<https://www.higoconnector.com/en/e-bike-connector/l615agc03dr0300>

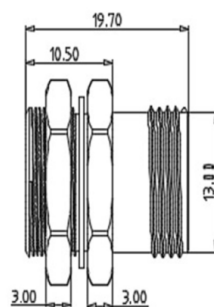

## Specifications

### General Characteristics

Number of contacts	6(2+4)
Connector shape	Panel mount
Gender	Male
Color	Black
Upper temperature	80 °C
Lower temperature	-25 °C
Locking	Screw locking
Protection degree	IP67
Mating cycles (times)	200 Mating times
Connector diameter	16.7 mm
Cable Length	Single wires 300 mm
Wire section	2 x 4,0 + 4 x 0,2 mm <sup>2</sup>
Remark	Other cable length/type on request

# Product data sheet

## Higo - Battery - L615A

### Male front panel mount connector

#### Electrical Parameters

<b>Rated current</b>	40 / 2 A
<b>Rated voltage</b>	48 V AC / 60 V DC
<b>Max. insulation resistance (M )</b>	≥20 MΩ
<b>Max. contact resistance (M )</b>	≤10 MΩ

#### Material

<b>Insulation wire</b>	PVC
<b>Material of contact</b>	Phosphor bronze
<b>Contact plating</b>	Gold over Nickel